

PROJECT DATA

2900 W SAMPLE ROAD  
POMPANO BEACH, FLORIDA

SITE DATA

FOLIO ID 4842.21.07.0010  
PARCEL SIZE 1,180,423 S.F. = 27.10 AC  
IMPACTED AREA 182,728 S.F. = 4.19 AC  
EXISTING ZONING B-3 & I-1  
EXISTING LAND USE C (COMMERCIAL) & I (INDUSTRIAL)

BUILDING DATA

PROPOSED RACETRAC MARKET BLDG. AREA 5,411 SF

PARKING DATA

TOTAL PARKING REQUIRED RACETRAC BLDG. 22 SPACES  
(2 SPACES + 1 SPACE X PUMP) = 2 SPACES + 1 SPACE X 20 PUMPS  
TOTAL PARKING REQUIRED FLEA MARKET BLDG. 764 SPACES  
(1 SPACE X 500 S.F.)

TOTAL PARKING REQUIRED 786 SPACES

TOTAL PARKING PROVIDED 974 SPACES

OPEN SPACE DATA

TOTAL PROP. SITE AREA 182,728 SF  
TOTAL ROW DEDICATION 6,079 SF  
TOTAL PROP. OPEN SPACE 94,682 SF

B.C.H.C.E.D. REF. NO. 200617002



666 N.E. 125th STREET,  
SUITE 247  
NORTH MIAMI, FL 33161  
Phone: 305.720.2079  
C.O.A. 33221

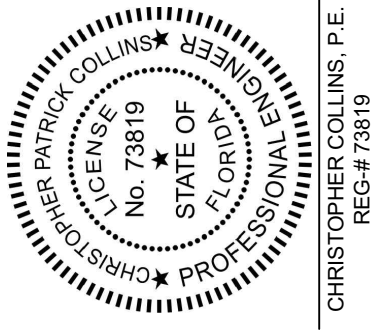

This item has been digitally signed and sealed by Christopher P. Collins, P.E. on the date adjacent to the seal.

Printed copies of this document are not considered signed and sealed and the signature must be verified on any electronics copies.



Christoph  
er Collins

Digitally signed  
by Christopher  
Collins  
Date: 2022.09.01  
11:22:52 -04'00'

Revision Date  
Comment

Revision Date  
Comment

Revision Date  
Comment

Revision Date  
Comment

Revision Date  
Comment

Revision Date  
Comment

Designed by: C.P.C.  
Drawn by: A.T.S.

Checked by: C.P.C.

Approved by: C.P.C.

Scale: 1" = 60'

Date: 05/25/2022

Job No.: I002

Plans for

**FESTIVAL  
MARKETPLACE**  
2900 W SAMPLE ROAD  
POMPANO BEACH,  
FLORIDA

**MASTER  
SITE PLAN**

Sheet No.

**C-6.0**

GRAPHIC SCALE

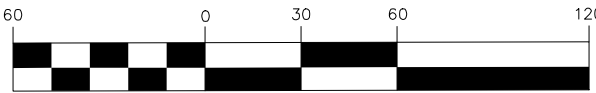

( IN FEET )

1 inch = 60 ft.

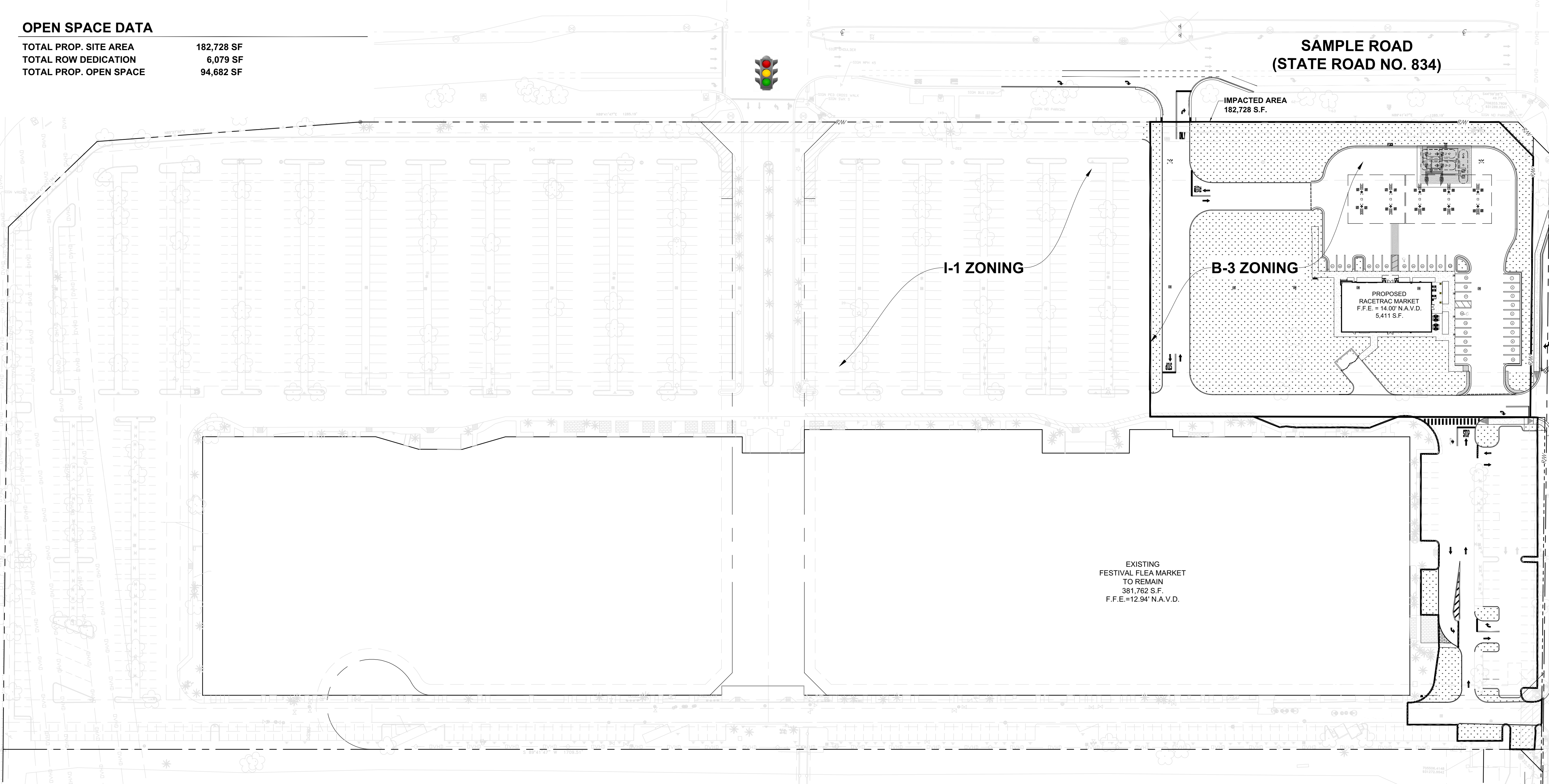

**PERMIT SET**  
MUST BE ON JOBSITE AT ALL  
TIMES DURING CONSTRUCTION

**NOTICE  
INSPECTION REQUIRED**  
24 HRS. PRIOR TO COMMENCING ANY  
WORK IN THE PUBLIC ROW CONTACT  
THE BROWARD COUNTY HIGHWAY  
CONSTRUCTION AND ENGINEERING  
DIVISION AT 954-577-4600 FOR  
INSPECTION.

**NOTE:**  
APPROVAL OF THIS PLAN DOES  
NOT CONSTITUTE A PERMIT FOR  
CONSTRUCTION.

A PERMIT FOR CONSTRUCTION MUST  
BE OBTAINED FROM THE BROWARD  
COUNTY HIGHWAY CONSTRUCTION  
AND ENGINEERING DIVISION PRIOR TO  
COMMENCING CONSTRUCTION IN THE  
PUBLIC RIGHT OF WAY.

ALL MATERIALS USED AND  
INSTALLATIONS WITHIN THE PUBLIC  
RIGHT OF WAY OR EASEMENTS SHALL BE  
IN ACCORDANCE WITH BROWARD COUNTY  
HIGHWAY CONSTRUCTION AND  
ENGINEERING DIVISION SPECIFICATIONS.

BROWARD COUNTY HIGHWAY CONSTRUCTION  
AND ENGINEERING DIVISION

- ☐ PLAN CONSISTENT  
WITH PLAT REQUIREMENTS  
☐ PUBLIC RIGHT OF WAY APPROVAL  
FOR PAVING, GRADING AND DRAINAGE

BY: \_\_\_\_\_ DATE: \_\_\_\_\_  
DOES NOT INCLUDE APPROVAL  
OF PAVEMENT MARKING & SIGNS

**DRC**

PZ22-12000027

10/5/2022



Call 811 or visit sunshine811.com two full  
business days before digging to have  
buried facilities located and marked.  
Check positive response codes before you dig!